

The Palo Post

“Gateway to the Outdoors”

January Calendar

January 19th Council Meeting 6:30pm
 January 20th Utility Bill Due
 January 22nd Open Gym 6-8pm
 January 25th Self-Defense Class 5pm
 January 27th P&Z Meeting 5pm
 January 29th Open Gym 6-8pm

February Calendar

February 2nd Shut Off- January Bill
 February 5th Open Gym 6-8pm
 Adult Pick Up Game 8-9pm
 February 5th WLCG Meeting 6:30pm
 February 8th Super Bowl
 February 9th P&Z Meeting 5:30pm
 Parks & Rec Meeting 6:30pm
 February 12th Open Gym 6-8pm
 Adult Pick Up Game 8-9pm
 February 14th Valentine’s Day
 February 16th President’s Day- City Hall &
 Community Center Closed
 February 17th Council Meeting 6:30pm
 February 19th Open Gym 6-8pm
 Adult Pick Up Game 8-9pm
 February 20th Utility Bill Due
 February 22nd Self-Defense Class 5pm
 February 26th Open Gym 6-8pm
 Adult Pick Up Game 8-9pm

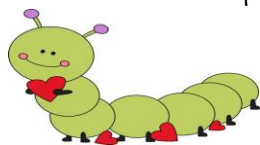

March Calendar

March 3rd Shut Off- February Bill
 March 5th WLCG Meeting 6:30pm
 March 5th Open Gym 6-8pm
 March 8th Daylight Savings Starts
 March 9th P&Z Meeting 5:30pm
 Parks & Rec Meeting 6:30pm
 Open Gym 6-8pm
 March 12th Council Meeting - 6:30pm
 March 16th St. Patrick’s Day
 March 17th Utility Bill Due
 March 20th Self-Defense Class 5pm
 March 22nd WLCG Egg Hunt – 10am
 March 28th Impact Life Blood Drive
 March 31st 3-6pm



City Hall

Monday – Friday

8:00 am- 4:00 pm

Phone: 319-851-2731

www.cityofpalo.com



SURFACE ENHANCEMENT COMPANY LLC

Premium Garage Floor Solutions for Discerning Homeowners
Locally Owned & Operated

Your garage is more than a place to park—it is an extension of your home. Surface Enhancement Company LLC delivers refined, high-performance concrete coating systems that elevate both appearance and durability.

Why Homeowners Trust Us

- Meticulous surface preparation for superior adhesion
- Industrial-grade coatings engineered for longevity
- Resistance to oil, chemicals, moisture, and tire pickup
- Seamless, low-maintenance finish with a clean, modern look
- Craftsmanship that enhances property value

Designed for Residential Garages

Ideal for single- and multi-car garages, workshops, storage areas, and home gyms. Our systems are tailored for homeowners who expect lasting quality and refined results.

Our Services

- Professional concrete surface preparation
- Premium protective floor coatings
- Crack and surface repair
- Optional slip-resistant finishes
- Clean, efficient, and professional installation

Schedule Your Complimentary Consultation

Phone: (319) 693-7594 | Location: Palo, IA

Enhancing Concrete. Enhancing Homes.

Mayor's Minute



Welcome to the first edition of our new community newsletter!

I am honored to serve as your mayor and excited to open this new line of communication. This is all about staying connected. To me, that begins with listening and ends with being open and transparent, and this newsletter will hopefully be a great way to keep everyone in the loop. In my first few weeks as mayor, I've been in awe at the strengths and talent of our city staff and volunteers – all the great things happening throughout town (and there are SO many!) are a direct result of these amazing individuals. I also know that everyone reading this has much to bring to our community. Please reach out with your ideas and questions as we work together during an incredibly exciting time in the journey and future of Palo!

– Bryan Busch [mayor@cityofpalo.com]



Palo City Council Meetings

The Palo City Council meets on the 3rd Monday of each Month at 6:30pm in the Council Chambers at City Hall.



Palo Community Gardens

Gardeners will pay an annual plot rental fee at the beginning of the season. Fees for the 2026 growing season are \$15.00 for a 10'x10' plot & \$25.00 for a 20'x25' plot. 2026 will be a trial growing season – only 21 spots available! Garden plots will be located behind City Hall next to the solar panels along Meadow Creek Dr. Water will be provided in a water tank. Bring your watering can for

watering your plot. If you have any questions, please contact Allison at City Hall by email, deputyclerk@cityofpalo.com, or by phone, 319-851-2731 ext. #3.

The deadline to sign up is April 3rd and deadline for payment is April 17



Local.

Palo, Iowa

Expanding Local Brands. Rebuilding Palo's Main Street.

Have you shopped Local yet? At Local. Palo, we proudly showcase the work of 30+ local artisans, makers, and big-dream thinkers. For the past year, we've been giving local brands a storefront to launch, grow, and connect with you and **now we're ready for our next chapter.**

This spring, **Local. Palo is moving** to a larger space at 606 First Street, and we're going bigger in every way. Think new brands, fresh merchandise, and even more small businesses ready to call Palo home.

Follow us on social media for updates, sneak peeks, and behind-the-scenes fun. Interested in joining our maker lineup? Reach out. We'd love to chat about adding your brand to the Local. Palo storefront.

Sell your items on consignment.

Support 30+ Eastern Iowa Brands

Shop new inventory every month!



Call or Text
(319) 743-5782



Visit Our Website
www.local-palo.com



Shop our Store
100 Vinton Street, Palo, Iowa



Like us on Facebook
Facebook.com/LocalPalolowa



Follow us on Instagram
Instagram.com/Local.Palo

Shellsburg Public Library

Did you know Palo city residents can get a library card from the Shellsburg Public Library?

Did you know you can use the Libby app through the Shellsburg Public Library? The Libby app allows you to borrow eBooks, audiobooks, magazines, and more to read on your phone or tablet.

Did you know the Shellsburg Public Library has current books and DVD/Blu-Ray movies to check out?

Did you know the Shellsburg Public Library has public computers and copy and fax services?

Did you know the Shellsburg Public Library has many activities which include book clubs, pre-K story hour, craft nights, summer reading programs, crochet class, and afternoon STEM programs for K-5?

Shellsburg Public library will charge Palo city residents \$25.00 to receive a library card. The library will provide a receipt and then the patron can take the receipt to the Palo city clerk and be reimbursed the \$25.00. It is absolutely free to have a library card with SPL!

RURAL PALO RESIDENTS CAN ALSO APPLY FOR A LIBRARY CARD AT SHELLSBURG,
THEY DO NOT HAVE TO PAY A FEE.

Shellsburg Public Library

110 Main Street

Shellsburg, IA 52332

319-436-2112

Facebook@ShellsburgIAPublicLibrary



Palo Parks and Recreation



Parks and Recreation

Palo Parks and Recreation meet on the second Monday of the month at 6:30pm at the Palo Community Center. There is also a virtual option. We would encourage members of the community to join us for these meetings.

Agendas with meeting links and minutes are posted on the City of Palo website under the Parks and Recreation Board. You may also reach out to

us directly at paloparksia@gmail.com and follow us on our Facebook page at Palo Parks &

Recreation. We had an amazing first year of Palo T-Ball in 2025 and are looking to replicate this in 2026. This will be for kids 3-6 years old. Please look for registration links coming soon. We will continue to hold open gym at the Community Center on Thursday nights from 6-8pm through March 12th. For the month of February, we are going to trial an adult open gym (18+) with pick-up basketball games from 8-9pm on Thursday nights, following open gym. As we are looking to expand our programming activities, we need volunteers! Please let us know if you are interested.

West Linn

SAVE THE DATES FOR OUR 2026 EVENTS!

Follow us on Instagram @palowestlinn
Follow us on Facebook

Visit us at ourwestlinn.com
Email us: westlinncommunitygroup@gmail.com



March 28

Look forward to an improved and fun Easter Egg Hunt this year



April 30- May 2

Host a garage sale or find deals at your neighbors



Summer Music Series June 11, July 9 & Aug 13

Relax and enjoy live music & food trucks in Clymer Park



August 14 & 15

A weekend celebration for Palo with activities for all ages



October 25

Wear your costumes and have fun trick or treating in a safe environment



November 15

Start your holiday shopping season at our Craft & Vendor Fair



December 6

A great family event with a visit from Santa, delicious soup and fun activities

Volunteer

West Linn meets at the Palo Community Center on the first Thursday of each month. Meetings are 6:30 - 7:30 pm and we would love to have you.

Donate or Sponsor

Our events cannot happen without the generous financial support of donors and sponsors. Thank you for your support!

Is your business interested in being a Community Sponsor or an Event Sponsor? Email us for all the details.

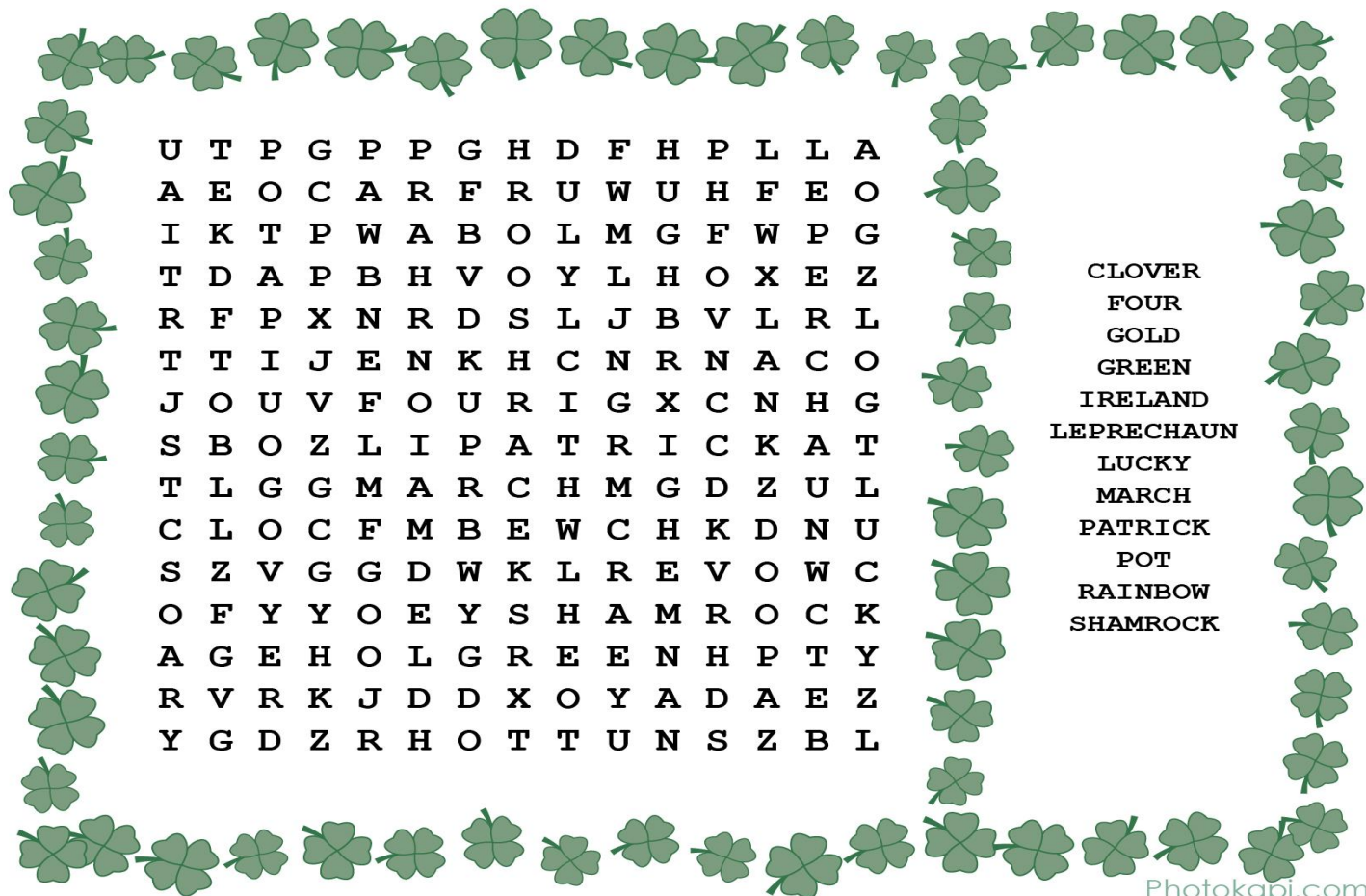

Ingredients

- 3 tablespoons of butter or margarine
- 1 package 10 oz. JET-PUFFED Marshmallows
- 6 cups Kellogg's® Rice Krispies® cereal



Directions

In microwave-safe bowl heat butter and marshmallows on HIGH for 3 minutes, stirring after 2 minutes. Stir until smooth. Add KELLOGG'S® RICE KRISPIES® cereal. Stir until well coated. Using buttered spatula or wax paper evenly press mixture into 13 x 9 x 2-inch pan coated with cooking spray. Cool. Cut into 2-inch squares. Best if served the same day. Microwave cooking times may vary. Note For best results, use fresh marshmallows. 1 jar (7 oz.) marshmallow creme can be substituted for marshmallows. Diet, reduced calorie or tub margarine is not recommended. Store no more than two days at room temperature in airtight container. To freeze, place in layers separated by wax paper in airtight container. Freeze for up to 6 weeks. Let stand at room temperature for 15 minutes before serving.



Palo Savings Bank

Member FDIC

We offer **Consumer, Agricultural, Commercial and Real Estate Loans.**
Stop in and visit with **Terry, Beth or Jon** for all your loan needs.



Serving YOUR community since 1908

Lobby Hours:

Mon-Thurs 9am-4pm
Friday 9am-5pm
Saturday 9am-Noon

Drive-Up Hours:

Monday-Friday 8am-5pm
Saturday 8am-Noon

Phone: (319) 851-2241

For Our Customers:

2025 Tax Information has been mailed – please check your mailboxes!



We will be **CLOSED** on **Monday February 16, 2026** to observe Presidents Day

Watch for our **Mobile Madness** promotion in **March!**

Please utilize our:

24-hour ATM
Night Depository
PSB Mobile App
Mobile Remote Deposit
Online Banking
www.palosavingsbank.com
PSB Account Transfers
Bill Pay/Transfers
Debit Cards w/Digital Wallet

Safe Deposit Boxes

Various size Boxes are Available

<u>SIZE</u>	<u>ANNUAL FEE</u>
3" x 5"	\$15
5" x 5"	\$25
3" x 10"	\$30
5" x 10"	\$50

2026 Golf Cart Permit

Make sure you get your 2026 Golf Cart Permit Sticker at City Hall! \$15 per Sticker/Golf Cart. You must get a new permit every year. 2026 stickers are valid from January 1st to December 31st, 2026.



Palo ²⁰²⁶ Farmers Market

Local. fresh. handmade.

May 31st
June 14th & 28th
July 12th & 26th
August 9th & 23rd
Sept. 13th

Sundays from 11am-3pm

Clymer Park Palo, IA

A decorative graphic for the Palo Farmers Market. It features a large pink flower with a yellow center, a smaller yellow flower, and a butterfly. The background is a light pink and white gradient.

Transportation Improvement Program
Federal Fiscal Years 2027-2031

Feb. 2026

Public Input Events

Tuesday, Feb. 24

Cedar Rapids Ladd Library

4:30 PM - 6:30 PM
3750 Williams Blvd SW
Cedar Rapids, IA 52404

Wednesday, Feb. 25

Marion Library

10:30 AM - 1:30 PM
1101 6th Avenue
Marion, IA 52302

Hiawatha Library

10:30 AM - 1:30 PM
150 W Willman Street
Hiawatha, IA 52233

Thursday, Feb. 26

Iowa Hall at Kirkwood Community College

11:00 AM - 1:00 PM
7005 Tower Rd SW
Cedar Rapids, IA 52404

Take the opportunity to attend one of these in-person events to assist decision-makers on how millions of dollars in federal transportation funds will be invested over the next five years

 **CORRIDOR**
MPO Metropolitan Planning
Organization
www.corridormpo.com

Palo Fire Department

The Palo Fire Department is always looking for new members. For more information contact the Palo Fire Chief by phone 319-851-4831 or palofire@gmail.com.

Find us on Facebook at Palo Fire Dept.

Be on the lookout for our upcoming events: Pancake Breakfast will be Sunday, April 25th & "Fire in the Hole" will be Saturday, July 25th.





Understanding Your Water / Sewer Bill

Here is how to breakdown your bill to understand how much you are consuming:

READINGS		CONSUMPTION USED	CODE	CURRENT CHARGES
PREVIOUS	PRESENT			
3169	3210	4100	GB - GARBAGE	25.53
3169	3210	4100	SW - SEWER	106.33
3169	3210	4100	WA - WATER	49.36
			ET - TAX	2.96

» Difference between previous & present readings on this bill (3210 - 3169) = 41 - this means that your household used 4100 gallons of water for the month.

» How Water is calculated:

- The first 1000 gallons for water is included in the initial charge of \$24.84
- So, $4100 - 1000 = 3100$
- To figure 3100 gallons at \$7.91/1000 gallons, you could take $\$7.91 \times 3.1 = \24.52
- $\$24.84 + \$24.52 = \$49.36$ for Water

» How Sewer is calculated:

- The first 1000 gallons for sewer is included in the initial charge of \$49.75
- So, $4100 - 1000 = 3100$
- To figure 3100 gallons at \$18.25/1000 gallons, you could take $\$18.25 \times 3.1 = \56.58
- $\$49.75 + \$56.58 = \$106.33$ for Sewer

» If you don't make a payment before the bill goes out, both last month and the current month bill will be added to the current bill, that will be listed under the code AR = Arrears

CITY OF PALO • 2800 HOLLENBECK RD • PALO, IOWA 52324 • (319) 851-2731

FROM	TO	BILLING DATE	PREV BALANCE
12/25/2025	1/31/2026	2/1/2026	0.00

PREVIOUS	PRESENT	CONSUMPTION USED	CODE	CURRENT CHARGES
3169	3210	4100	GB	25.53
			SW	106.33
3169	3210	4100	WA	49.36
			ET	2.96

ACCOUNT NUMBER	DUE DATE
184.18	12/26/2022
AMOUNT DUE NOW	
184.18	184.18

PROPERTY LOCATION

RETURN THIS STUB WITH PAYMENT

ACCOUNT NUMBER	DUE DATE
184.18	2/20/2026
AMOUNT DUE NOW	
184.18	184.18

CITY OF PALO
2800 HOLLENBECK RD.
PALO, IOWA 52324
(319) 851-2731
Web: cityofpalo.com

* CODE IDENTIFICATION
TX — TAX
SW — SEWER
WA — WATER
PN — PENALTY CHARGE
GB — GARBAGE
MC — MISCELLANEOUS CHARGE
AR — ARREARS

RETAIN THIS PORTION FOR YOUR RECORDS

REMIT TO:
CITY OF PALO
2800 HOLLENBECK RD.
PALO, IOWA 52324
(319) 851-2731
Web: cityofpalo.com

PLEASE RETURN THIS PORTION WITH YOUR PAYMENT

Sanitary Sewer Rate Increase Table
Sets Reserve Fund Value at \$25,000
3.5% Automatic Annual Increase

City of Palo - Sanitary Sewer Rates

Effective Period		Base Rate	Unit Rate
Start	End	Frist 1000 gal.	Per Additional 1000 gal.
1/1/2026	6/30/2026	\$49.75	\$18.25
7/1/2026	6/30/2027	\$52.74	\$19.35
7/1/2027	6/30/2028	\$55.90	\$20.51
7/1/2028	6/30/2029	\$59.25	\$21.74
7/1/2029	6/30/2030	\$62.81	\$23.04
7/1/2030	6/30/2031	\$66.58	\$24.42
7/1/2031	6/30/2032	\$70.57	\$25.89
7/1/2032	6/30/2033	\$74.81	\$27.44
7/1/2033	6/30/2034	\$79.29	\$29.09
7/1/2034	6/30/2035	\$84.05	\$30.83

Water Rate Increase Table
Sets Reserve Fund Value at \$25,000
3.5% Automatic Annual Increase

City of Palo - Water Rates

Effective Period		Base Rate	Unit Rate
Start	End	Frist 1000 gal.	Per Additional 1000 gal.
7/1/2025	6/30/2026	\$24.84	\$7.91
7/1/2026	6/30/2027	\$25.70	\$8.18
7/1/2027	6/30/2028	\$26.60	\$8.47
7/1/2028	6/30/2029	\$27.54	\$8.76
7/1/2029	6/30/2030	\$28.50	\$9.07
7/1/2030	6/30/2031	\$29.50	\$9.39
7/1/2031	6/30/2032	\$30.53	\$9.72
7/1/2032	6/30/2033	\$31.60	\$10.06
7/1/2033	6/30/2034	\$32.71	\$10.41
7/1/2034	6/30/2035	\$33.85	\$10.77

**** New Rates will go into effect on your February 2026 Bill ****



With Spring just a few months away, have you thought about installing a 2nd meter for outside use only? The 2nd outside meter ONLY charges for water usage, NO Sewer fees!

You can also rent a water meter for up to 4 days if needed to fill up your pool, wash your house, or any other outside project. Get yours installed today! Contact City Hall for more information on purchasing or renting availability on a water meter at 319-851-2731.

Palo Community Center

The Palo Community Center is available to rent. You can rent the gym, kitchen, library, or Council Chambers for your event. Contact City Hall for details.

Open gym is offered Monday - Thursday from 9:00am-3:30pm during regular business days.

OPEN GYM



Monday-Thursday
9 am- 3:30 pm

Please SIGN-IN at City Hall Office prior to Entering!

Baseballs/Softballs are NOT ALLOWED in the Gym!

Walt's Lawn Care & Maintenance
(319) 521-1329

tic ♥ tac ♥ toe

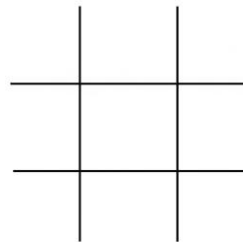

tic ♥ tac ♥ toe

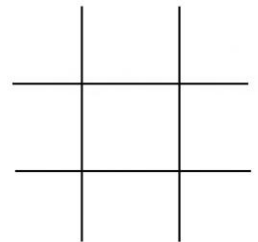

tic ♥ tac ♥ toe

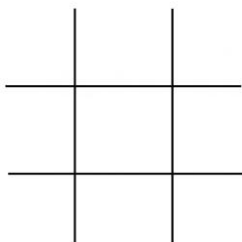

tic ♥ tac ♥ toe

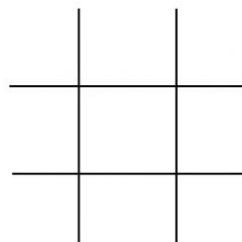

tic ♥ tac ♥ toe

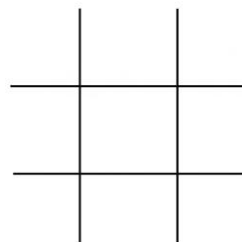

tic ♥ tac ♥ toe

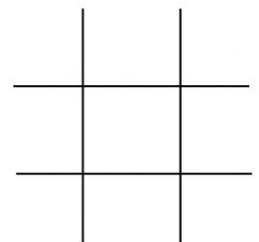



Good neighbor. Great auto rates.

I can help you get the right auto coverage at a great rate. Call, click or stop by for a quote today.

Kari Klien Ins and Fin Svc Inc
Kari Klien, President
3011 Johnson Ave NW
Cedar Rapids, IA 52405-4628

Bus: 319-396-3222
kari@sfklien.com
www.sfklien.com

Like a good neighbor, State Farm is there.®

State Farm Mutual Automobile Insurance Company
State Farm Indemnity Company
Bloomington, IL

State Farm County Mutual Insurance Company of Texas
Richardson, TX



MIKE WOOD MEMORIAL FOOD PANTRY

Open Every Thursday 3:30 PM to 5:00 PM

Or by appointment: 319-851-4731 or 319-560-4769



A mission of the Palo United Methodist Church

In Partnership with HACAP



Effective July 1 of each year all Food Pantry patrons must complete the TEFAP form and will need to sign in at each visit.

This institution is an equal opportunity provider.

Palo United Methodist Church

Anchoring our

Community Since 1870.

Palo United Methodist Church

118 Clinton Street

319-851-4731

Sunday Worship 9:00 AM

Wednesday Bible School 5:30 – 7:00 PM

Follow us on Facebook.



Future Road Closure- Covington Bridge Closure

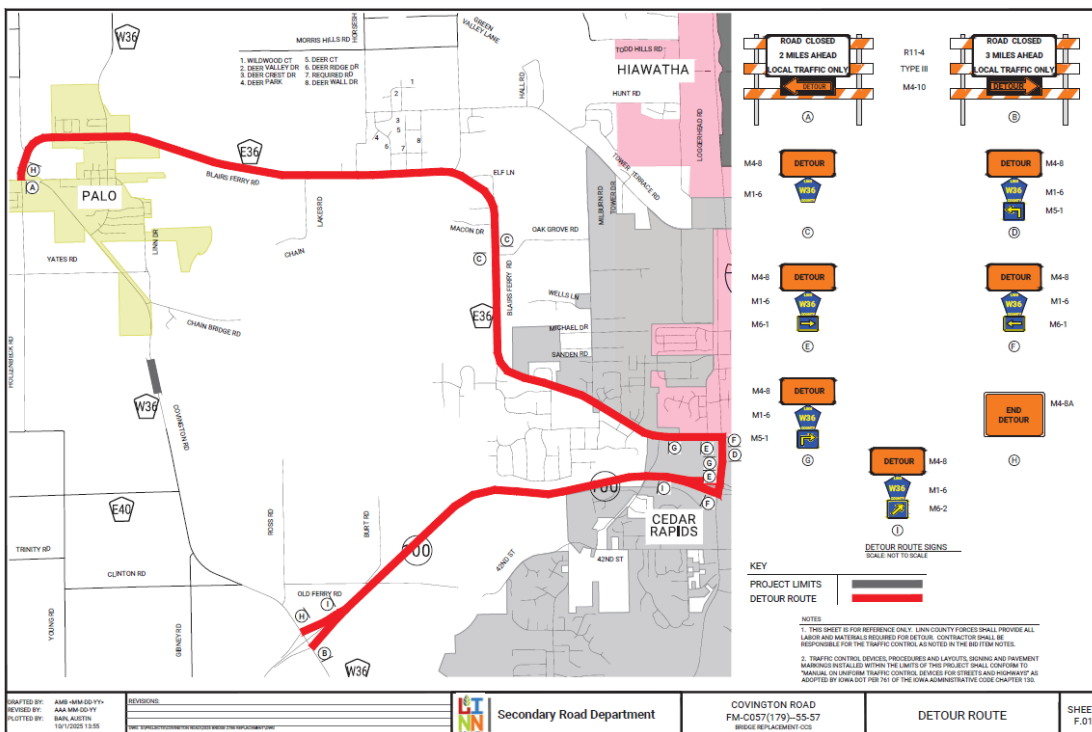

There is an upcoming Covington Rd. bridge project coming approx. Spring/Summer of 2026 south of Palo.

It will take approximately 4 months to finish. More information to come as it gets finalized!



"Connecting people, through communication"

FIBER INTERNET IPTV PHONE

www.goptca.com

319-851-3431

MONDAY: 8:00AM-4:30PM
TUESDAY: 8:00AM-4:30PM
WEDNESDAY: 8:00AM-4:30PM
THURSDAY: 8:00AM-4:30PM
FRIDAY: 8:00AM-4:30PM



807 2ND St. Palo, IA. 52324

City of Palo Recycling Schedule

Recycle is every other Monday. Green indicates a recycle pick-up day.

2026

January							February							March						
Su	Mo	Tu	We	Th	Fr	Sa	Su	Mo	Tu	We	Th	Fr	Sa	Su	Mo	Tu	We	Th	Fr	Sa
				1	2	3	1	2	3	4	5	6	7	1	2	3	4	5	6	7
4	5	6	7	8	9	10	8	9	10	11	12	13	14	8	9	10	11	12	13	14
11	12	13	14	15	16	17	15	16	17	18	19	20	21	15	16	17	18	19	20	21
18	19	20	21	22	23	24	22	23	24	25	26	27	28	22	23	24	25	26	27	28
25	26	27	28	29	30	31								29	30	31				

April							May							June						
Su	Mo	Tu	We	Th	Fr	Sa	Su	Mo	Tu	We	Th	Fr	Sa	Su	Mo	Tu	We	Th	Fr	Sa
			1	2	3	4						1	2		1	2	3	4	5	6
5	6	7	8	9	10	11	3	4	5	6	7	8	9	7	8	9	10	11	12	13
12	13	14	15	16	17	18	10	11	12	13	14	15	16	14	15	16	17	18	19	20
19	20	21	22	23	24	25	17	18	19	20	21	22	23	21	22	23	24	25	26	27
26	27	28	29	30			24	25	26	27	28	29	30	28	29	30				
							31													

July							August							September						
Su	Mo	Tu	We	Th	Fr	Sa	Su	Mo	Tu	We	Th	Fr	Sa	Su	Mo	Tu	We	Th	Fr	Sa
			1	2	3	4							1			1	2	3	4	5
5	6	7	8	9	10	11	2	3	4	5	6	7	8	6	7	8	9	10	11	12
12	13	14	15	16	17	18	9	10	11	12	13	14	15	13	14	15	16	17	18	19
19	20	21	22	23	24	25	16	17	18	19	20	21	22	20	21	22	23	24	25	26
26	27	28	29	30	31		23	24	25	26	27	28	29	27	28	29	30			
							30	31												

October							November							December						
Su	Mo	Tu	We	Th	Fr	Sa	Su	Mo	Tu	We	Th	Fr	Sa	Su	Mo	Tu	We	Th	Fr	Sa
				1	2	3	1	2	3	4	5	6	7			1	2	3	4	5
4	5	6	7	8	9	10	8	9	10	11	12	13	14	6	7	8	9	10	11	12
11	12	13	14	15	16	17	15	16	17	18	19	20	21	13	14	15	16	17	18	19
18	19	20	21	22	23	24	22	23	24	25	26	27	28	20	21	22	23	24	25	26
25	26	27	28	29	30	31	29	30						27	28	29	30	31		

**** Garbage tags can be purchased at City Hall & Casey's for \$1.50 each ****



Business Name: _____

Phone: _____

Email: _____

Gateway to the Outdoors

Would you like to be an Advertiser in The Palo Post??

The Palo Post Advertisement rates-
effective January 2026 thru October 2026 (4 issues per year)

_____ Business Card approx. 3 ½ X 2 ¼”	\$35 year
_____ Business Card approx. 3 ½ X 2 ¼”	\$10 per one time issue
_____ Medium (quarter page) approx. 3 ½ X 4 ½”	\$50 year
_____ Medium (quarter page) approx. 3 ½ X 4 ½”	\$15 per one time issue
_____ Large (half page) approx. 7 ½ X 4 ½”	\$75 year
_____ Large (half page) approx. 7 ½ X 4 ½”	\$20 per one time issue
_____ Full Page approx. 7 ½ X 10”	\$125 year
_____ Full Page approx. 7 ½ X 10”	\$40 per one time issue

**** Newsletter will be printed in Black & White ****

Please email Allison Groff at deputyclerk@cityofpalo.com of what you would like to be advertised. Will try to keep as close to submission but may need to alter as needed. Must have submitted by the 20th of the month prior to release of Issue.

Issues will be released: January – April – July – October

If you would like The Palo Post mailed to you, it would be \$15 for the year.

Check# _____ Cash _____ Credit Card _____ Payment Received _____

Contact Allison Groff, Deputy Clerk at 319-851-2731 ext. #3 or deputyclerk@cityofpalo.com if you have any questions. Thank you.